

HOW TO MOUNT A GRAPHIC PANEL FOR THE FIRST TIME

**DO NOT REMOVE THE HEX KEY IN THE END OF THE UNIT
UNTIL THE GRAPHIC PANEL IS APPLIED!**

THE FOLLOWING ITEMS WILL BE NEEDED TO SET-UP YOUR NEW ROLL-UP.

DENATURATED ALCOHOL



CLOTH TOWEL



NEW HANDLE
& MOUNTING STRIP (SUPPLIED)

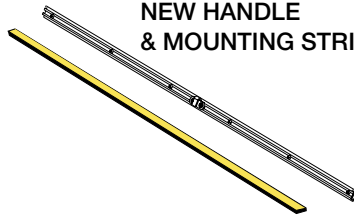

PHILLIPS SCREWDRIVER

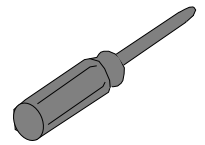

1

Apply denatured alcohol to a clean cloth and wipe the back side of the graphic. On the mounting strip, peel off the covering on the adhesive and mount the strip to the top backside of the graphic.

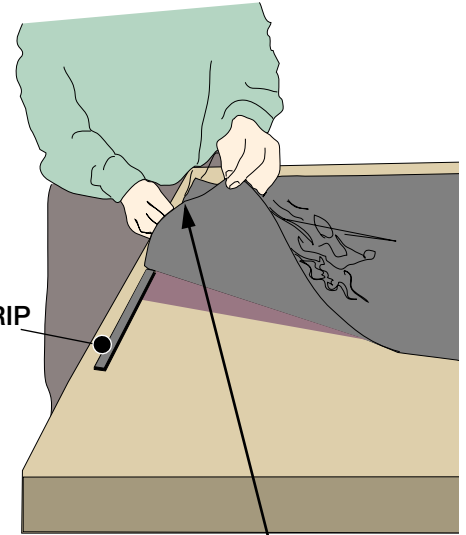

2

Slip the mounting strip & graphic into the clamping channel in the handle. (See DIAGRAM 1)

DIAGRAM 1

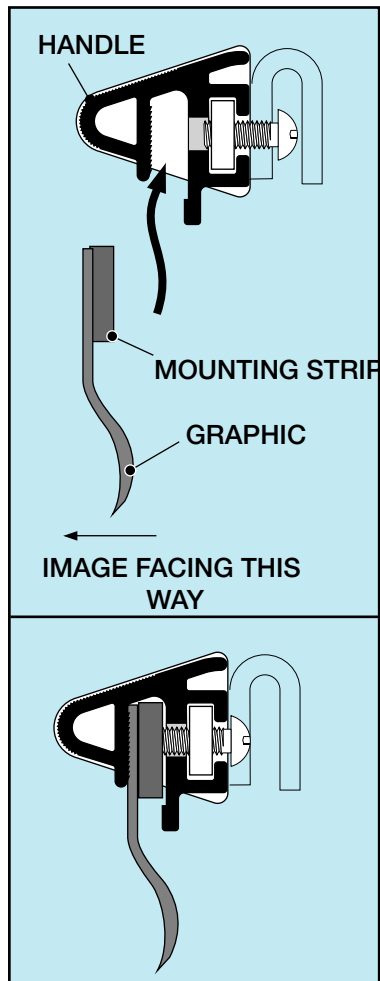

3

While holding the graphic panel into the handle slot, tighten the six mounting screws. Be sure not to over tighten the screws.

DO NOT REMOVE THE BLACK PLASTIC CAPS!

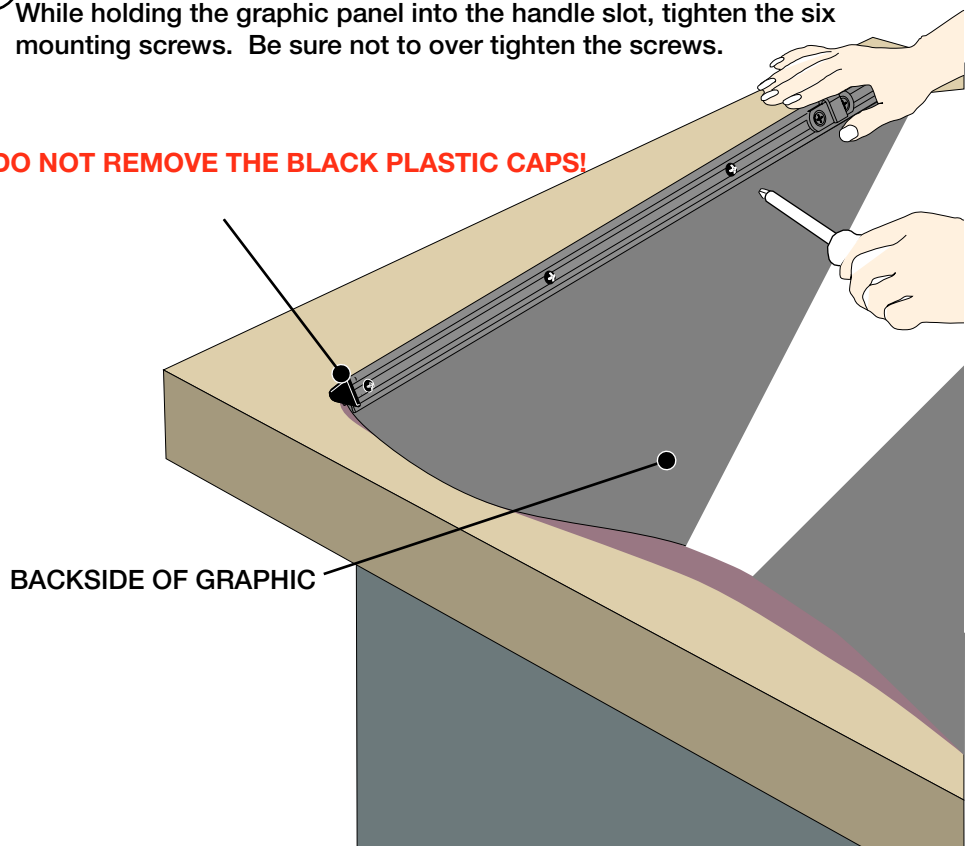

Instructions continued on the following page.

HOW TO MOUNT A GRAPHIC PANEL FOR THE FIRST TIME

4

Wipe clean the bottom front of the graphic & attach the bottom front of the graphic to the adhesive on the white plastic leader. Be sure to align the edge of the graphic to the first red line nearest the adhesive.

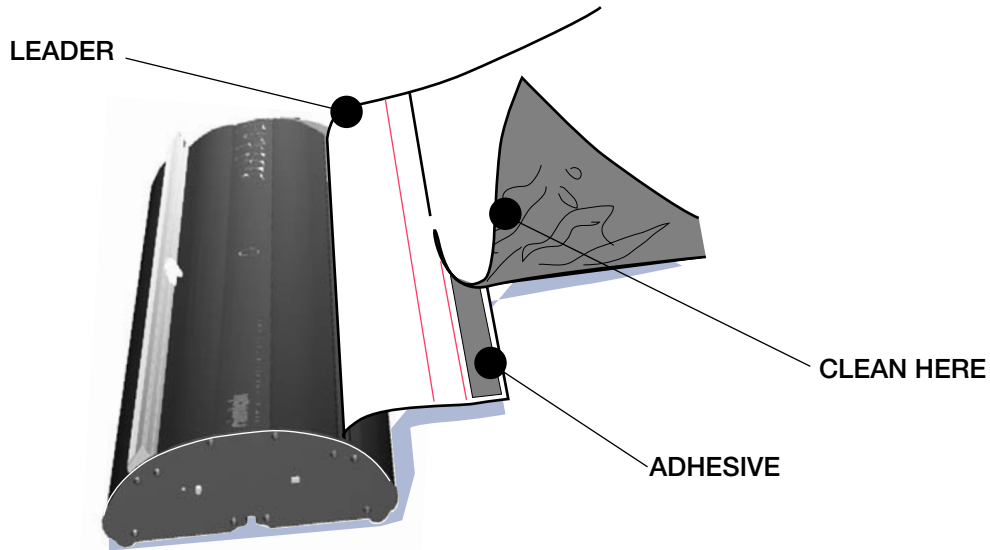

5

After the graphic has been applied to the base unit, the adhesive tape must cure for a minimum of 24 HOURS without spring tension. Failing to follow this procedure will cause the adhesive to prematurely fail and damage the graphic.

6

After curing for 24 hours or more, activate the spring tension by removing the Allen key. Pull the Allen Key while holding on to the attached graphic panel. Slowly let the panel roll into the housing. Save the key under the system or in the bag.

7

Go back to step 1 and repeat these steps for mounting the second side.

DO NOT REMOVE THE ALLEN KEY IN THE END OF THE UNIT UNTIL THE GRAPHIC PANEL IS APPLIED!



HOW TO REPLACE AN EXISTING GRAPHIC PANEL

TO DO THE FOLLOWING PROCEDURE THESE ITEMS WILL BE NEEDED.

DENATURED ALCOHOL



CLOTH TOWEL



UTILITY KNIFE

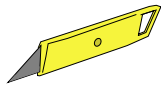

STRAIGHT EDGE

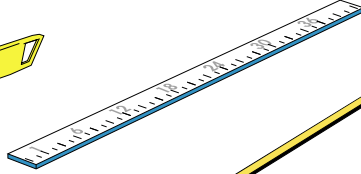

NEW MOUNTING STRIP

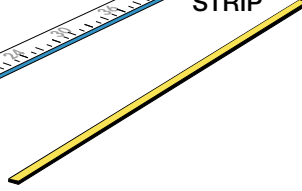

NIMLOK DOUBLE SIDED TAPE



PHILLIPS SCREWDRIVER

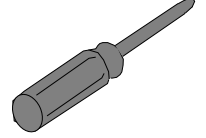

1

Pull out the panel completely.

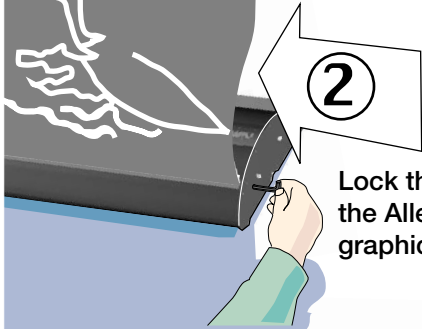

2

Lock the spring system with the Allen Key and remove the graphic.

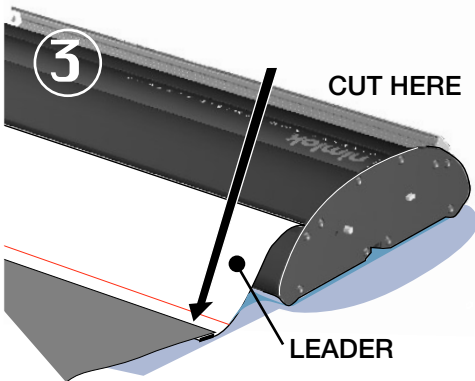

3

CUT HERE

Using a straight edge, cut off the panel at the red line near the adhesive.

LEADER

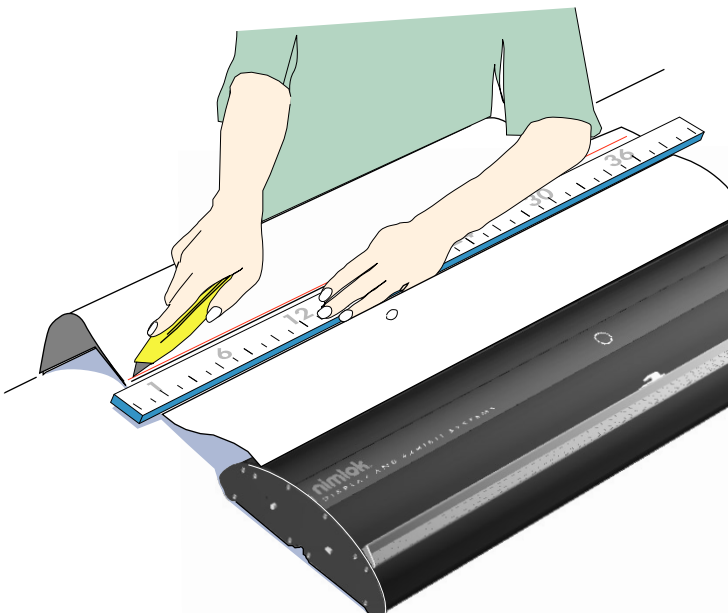

4

Clean the graphic & leader with denatured alcohol before applying NIMLOK double sided tape* on the white PVC.

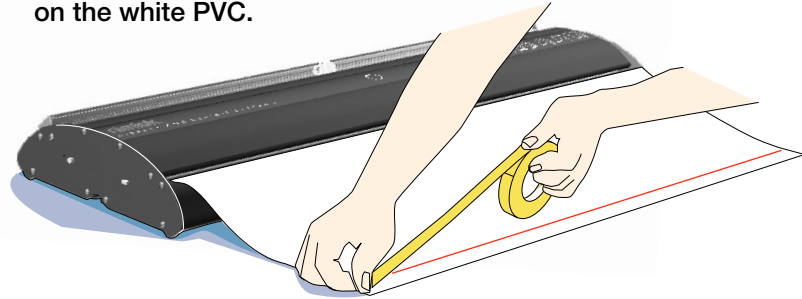

5

Unscrew the 6 mounting screws and pull out the old graphic from the handle.

DO NOT REMOVE THE BLACK PLASTIC CAPS!

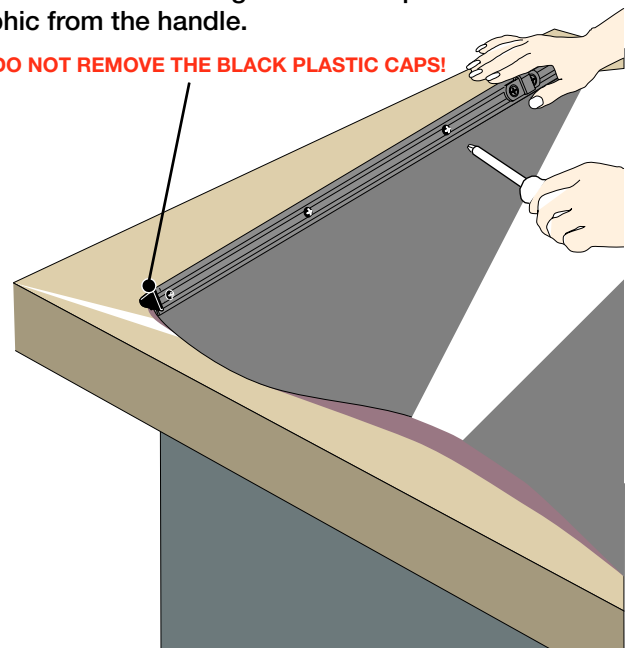

Instructions continued on the following page.

HOW TO REPLACE AN EXISTING GRAPHIC PANEL

6

Apply denatured alcohol to a clean cloth and wipe the back side of the new graphic. On the mounting strip, peel off the covering on the adhesive and mount the strip to the top backside of the graphic.

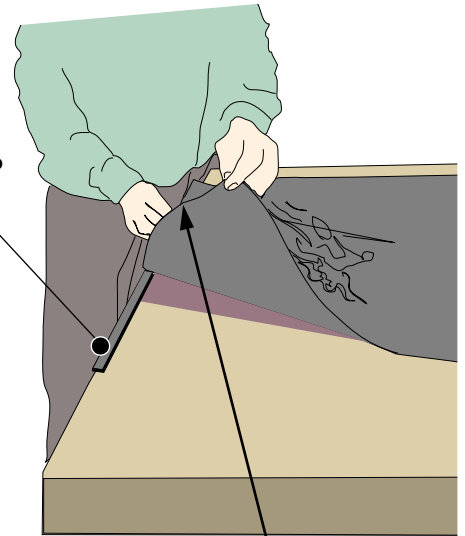

MOUNTING STRIP

CLEAN HERE

7

Slip the mounting strip & the graphic attached to it into the channel in the handle. (See DIAGRAM 1)

DIAGRAM 1

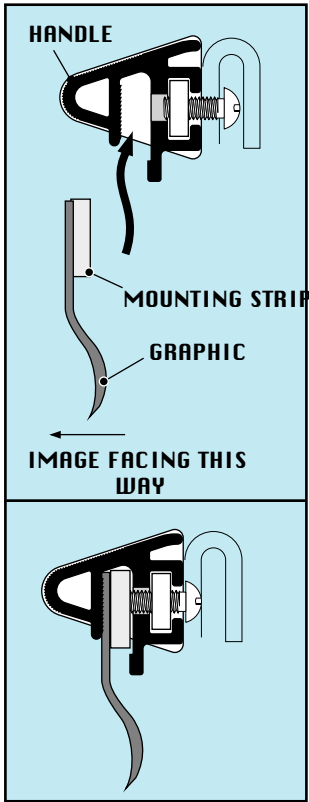

8

While holding the graphic panel into the handle slot, tighten the six mounting screws. Be sure not to over tighten the screws.

DO NOT REMOVE THE BLACK PLASTIC CAPS!

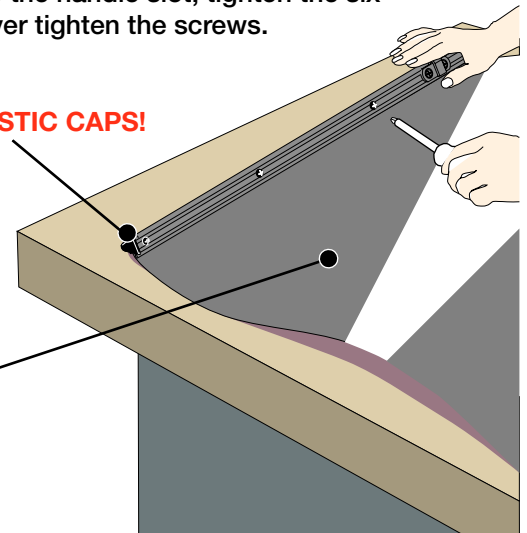

BACKSIDE OF GRAPHIC

9

Wipe clean the bottom front of the graphic & attach the bottom front of the graphic to the adhesive on the white plastic leader. Be sure to align the edge of the graphic to the first red line nearest the adhesive.

10

After the graphic has been applied to the handle and the base unit, the adhesive tape must cure for a minimum of 24 HOURS without spring tension. Failing to follow this procedure will cause the adhesive to prematurely fail and damage the graphic.

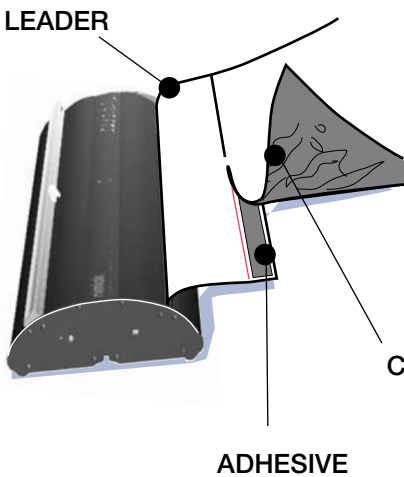

CLEAN HERE

11

After curing for 24 hours or more, activate the spring tension by removing the Allen Key. Pull the key while holding on to the attached graphic panel. Slowly let the panel roll into the housing. Save the Key under the system or in the bag.

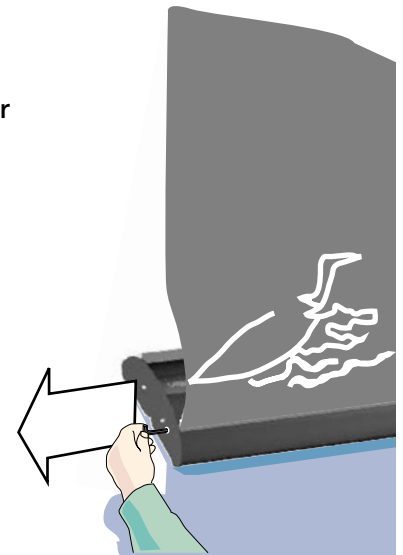

DO NOT REMOVE THE ALLEN KEY IN THE END OF THE UNIT UNTIL THE GRAPHIC PANEL IS APPLIED!

*Contact your Nimlok distributor for the proper materials.

HOW TO REAPPLY A GRAPHIC PANEL TO THE ROLLER

TO DO THE FOLLOWING PROCEDURE THESE ITEMS WILL BE NEEDED.

DENATURATED ALCOHOL



CLOTH TOWEL



NIMLOK DOUBLE SIDED TAPE

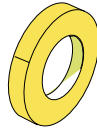

PHILLIPS SCREWDRIVER MASKING TAPE

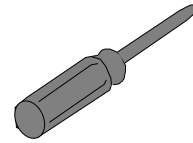

- 1** Remove the two outer screws at both ends.

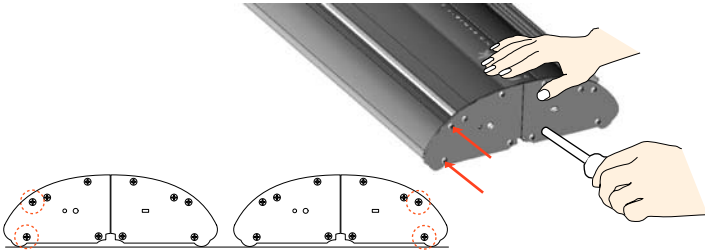

- 5** Lock the spring system with the Allen Key. Remove the tape and roll out the PVC. Put the cover back in its place and reinstall the screws.

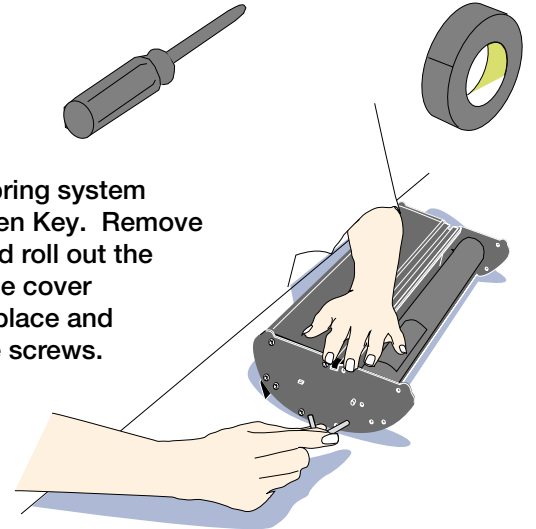

- 2** Remove the cover.

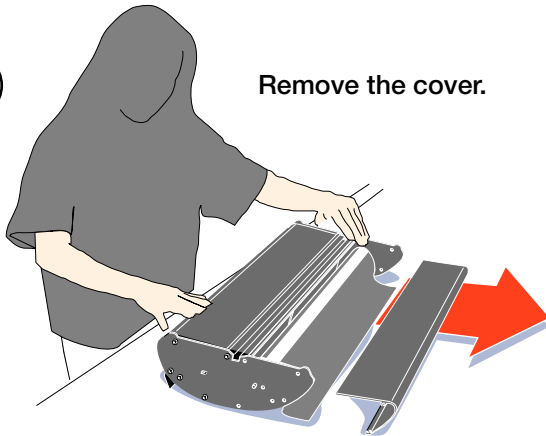

- 6** Make a Cut 1/2" from the end of the white leader to remove the old adhesive tape.

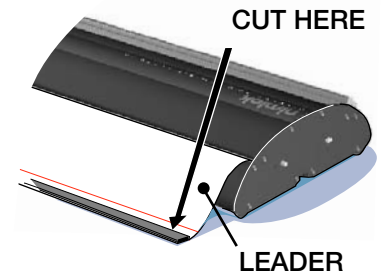

- 3** Wind up the white PVC & tape it to the roll with masking tape.

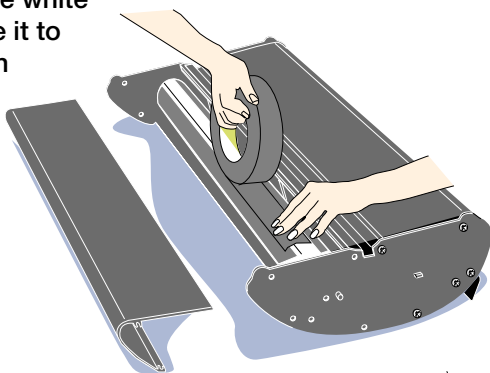

- 7** Place a new special double-adhesive tape* strip between the end of the white PVC sheet and red line.

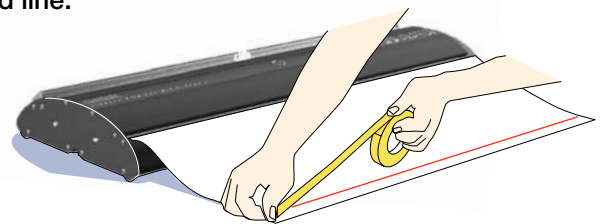

- 4** Activate the spring by rolling the roller away from yourself until it stops. (approx. 45 turns) Then let it go back one revolution.

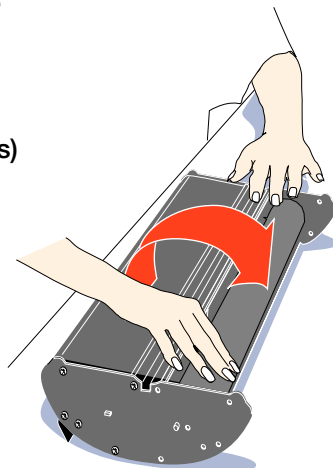

- 8** Mount the panel according to the instructions on pages 1 & 2.

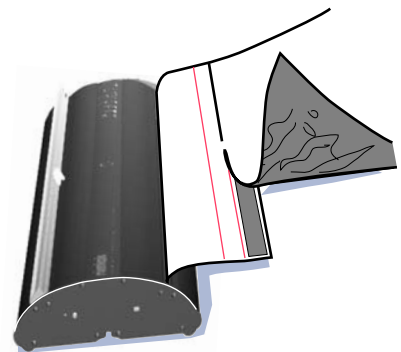

*NIMLOK RECOMMENDS ONLY USING ADHESIVE TAPES AVAILABLE THROUGH NIMLOK DISTRIBUTORS.

WHAT TO DO WHEN YOU ACCIDENTALLY PULL THE ALLEN KEY

TO DO THE FOLLOWING PROCEDURES THESE ITEMS WILL BE NEEDED.

PHILLIPS SCREWDRIVER MASKING TAPE



- 1** Remove the two outer screws at both ends.

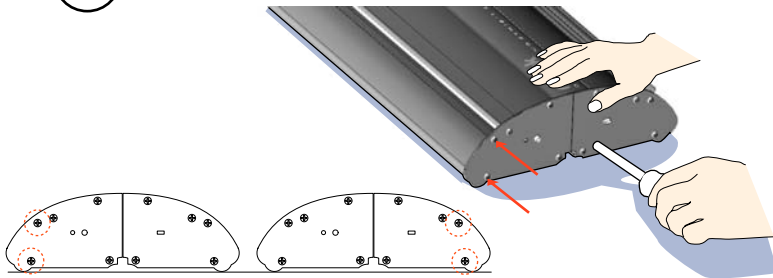

- 4** Activate the spring by rolling the roller away from yourself until it stops. (approx. 45 turns) Then let it go back one revolution.



- 2** Remove the cover.



- 3** Wind up the white PVC & tape it to the roll with masking tape.

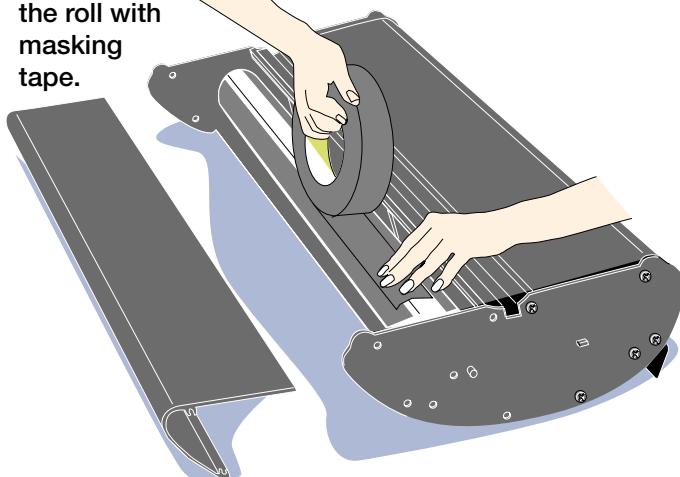

- 5** Lock the spring system with the Allen Key. Remove the tape and roll out the PVC. Put the cover back in its place and reinstall the screws.

