

1. To remove the graphic cassette open the trapper frame.

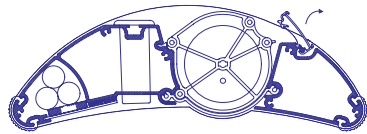

2. Grasp and remove the cassette.

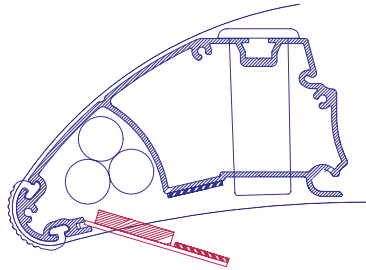
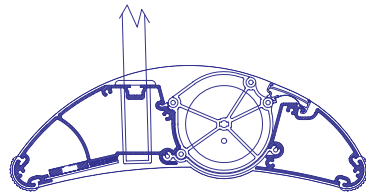
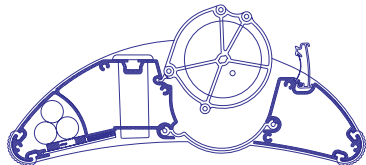

3. When closing the pole storage please ensure the plastic strip is resting in the groove of the aluminium extrusion as shown below.

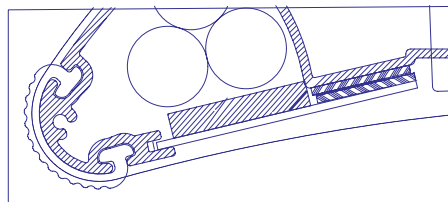

4. By locking PHC extrusion to the channel on the body of the banner (see below) allows you to add literature holders and other Nimlok components.

Note: Ensure the lip of the PHC is facing away from the graphic

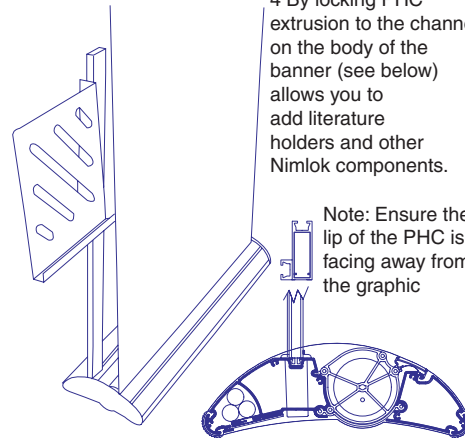

5. Another method of attaching PHC is utilising the end plates, a piece of NLE aluminium extrusion is attached to the side and the PH slides over. Please specify this method when ordering. Please note: addition bracing may be required when using this method

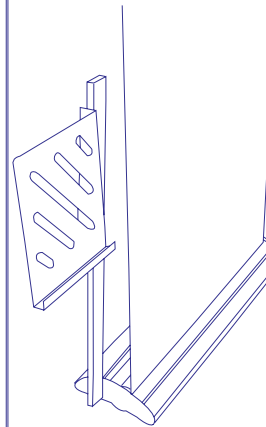

Applying the graphic

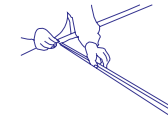

1. On the mounting strip, peel off the backing paper from the adhesive and mount the strip to the top backside of the graphic.

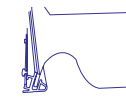

2. Slip the mounting strip and the graphic into the clamping channel in the top strip.

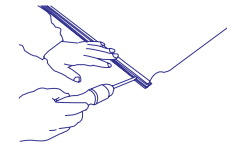

3. Whilst holding the graphic panel in the channel, tighten to six mounting screws. Be sure not to over-tighten

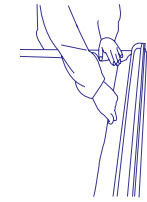

4. Ensure the hex key is inserted before starting this process. Wipe clean the bottom of the graphic and attach it to the adhesive on the white leader. We recommend when using a fabric graphic panel that you apply a second piece of Nimlok double sided tape on top of the joint.



5. After the graphic has been applied the adhesive tape must cure for a minimum of 24 hours, before spring tension is applied.