

Easy 3

set-up instructions

1 Assembly

There are two sets of panels in a full-height unit, a top section and a base section. The top section (Fig. A) has location pins along the base of the panels. The bottom section (Fig. B) has rubber feet along the bottom. **The correct orientation of the top and base panels is maintained by making sure that the white sticker in the frame of the top panel matches the white sticker in the frame of the base panel, which should be oriented on the right side of the unit as you face it.**

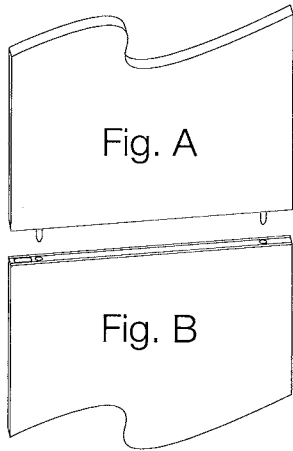

2 Stacking

To assemble, place the bottom section upright on the floor. Next, place the top section, with the pins facing downward, on top of the bottom section and align pins with pin holes on bottom section.

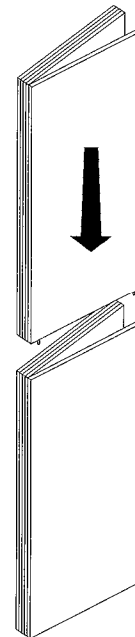

4 Add Optional Curved Panels

Top and base curved end panels are identified with a sticker on the back of each panel.

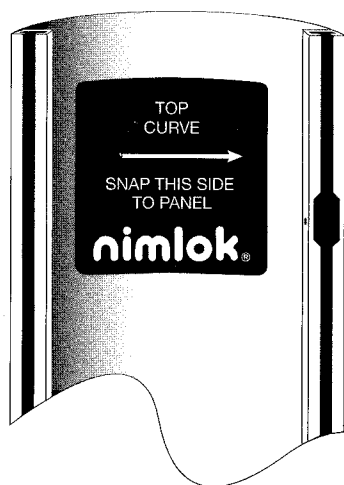

End flat panels have three connectors along the edge which attach curves. Attached curves by sliding cut-out sections of curve edge, located at dot position, over and down on panel connectors as shown.

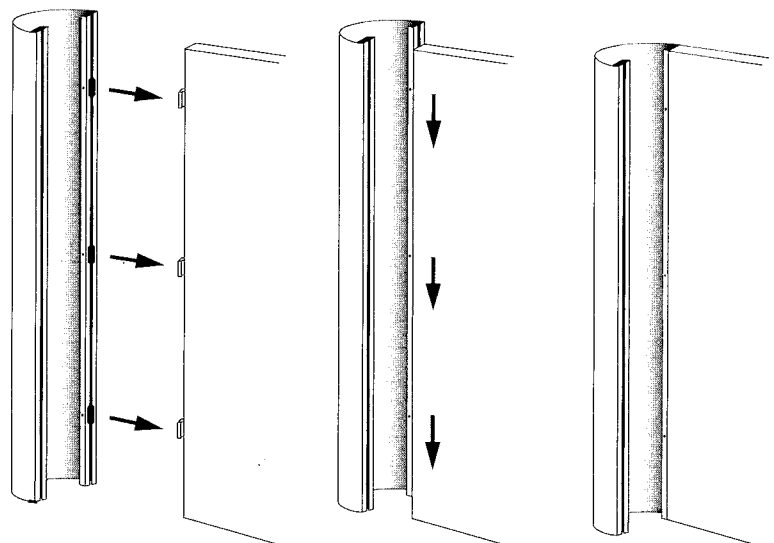

3 Unfold Display

Unfold the display to the desired configuration by holding the bottom section and swinging outward in the direction of the arrows.

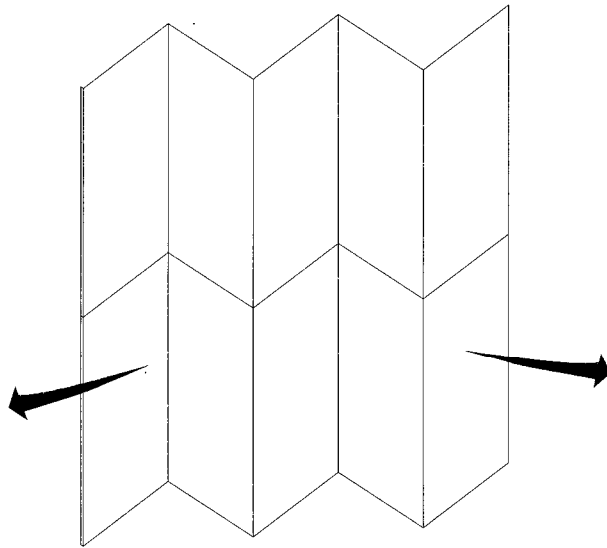

nimlok.

DISPLAY AND EXHIBIT SOLUTIONS WORLDWIDE
WWW.NIMLOK.COM

5 Add Accessories

Center the header on the display as desired and hang with attached header hooks.

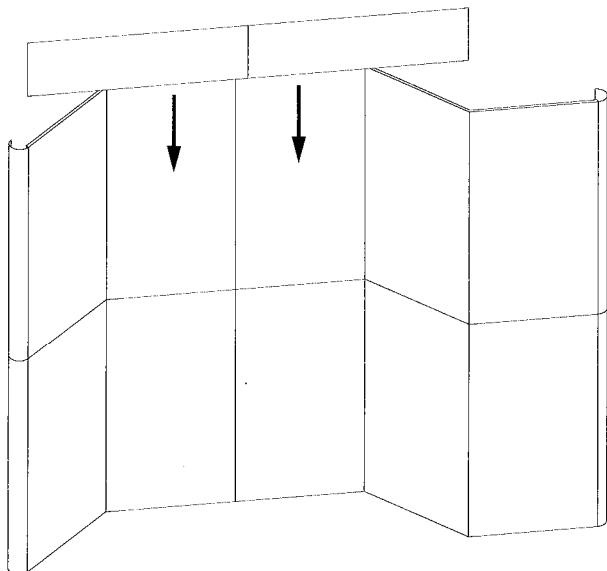

6 Packing

Careful repacking of your exhibit will lead to years of use.

